

LET	REVISION DESCRIPTION	BY	ECN #	DATE
A	ORIGINAL RELEASE	D.A.	05586340	04/11/2012
B	1)WAS $\phi 1.043$ MIN. 2)WAS R.030 3)ADDED TOLERANCE 4)ADDED RADIUS	D.A.	05586340-Rev1	05/11/2012
C	1)ADDED BASE ENGRAVING + DATE CLOCK	D.A.	05586340-Rev2	05/13/2012
D	1)WAS 3 TURNS OF THREAD @ 4mm PITCH (NOTE WAS INCORRECT)	D.A.	05586340-Rev3	08/21/2012
E	1)ADDED S&S + MOLD NUMBER 2)WAS 5.302 3)WAS 5.302 4)S WAS $.241 \pm .015$ 5)OAH WAS 11.637 6)ADDED PUSH-UP DIM. 7)OFC WAS 2462ml 8)ADDED SLANT SPEC.	D.A.	08400740	03/10/2020

- NOTES:  
 1. INTERPRET DRAWING TO ASME Y14.5M - 1994  
 2. DO NOT SCALE DRAWING  
 3. ALL NECK FINISH DIAMETER DIMENSIONS ARE THE AVERAGE OF TWO MEASUREMENTS TAKEN ACROSS THE MAJOR AND MINOR AXIS. THE LIMITS OF OVALITY ARE (.036).  
 4. THREAD SPEC = SINGLE LEAD, 6 T.P.I. (.1667" PITCH), 2 REVOLUTIONS. (D)  
 5. MIN. WALL THICKNESS IN PANEL = .038  
 6. MIN HEEL = .032  
 7. MIN. TAIL SCAR = .075  
 8. TOP FLATNESS ON SEALING SURFACE MAX. = .015

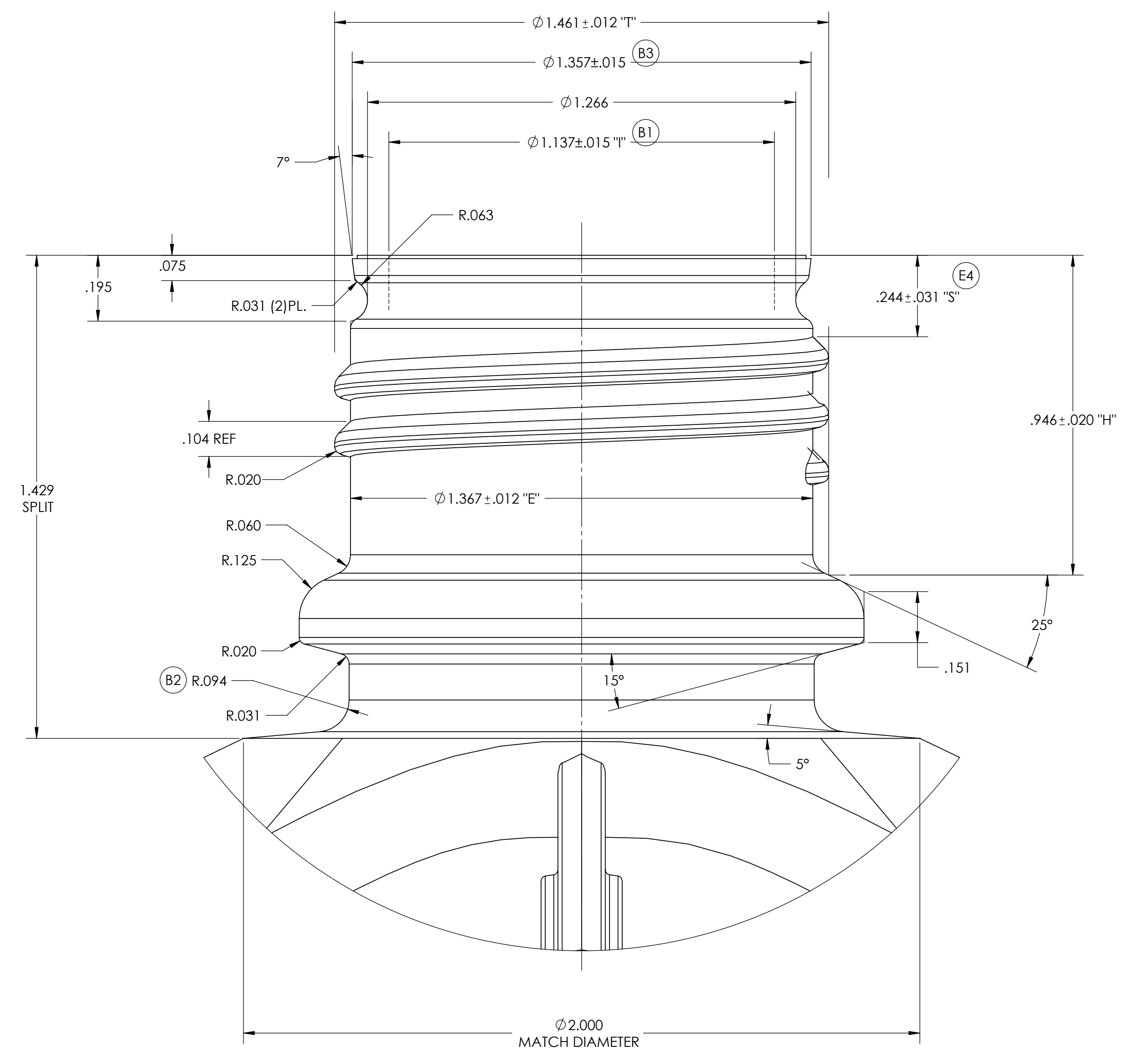

**DETAIL A**  
SCALE 4 : 1

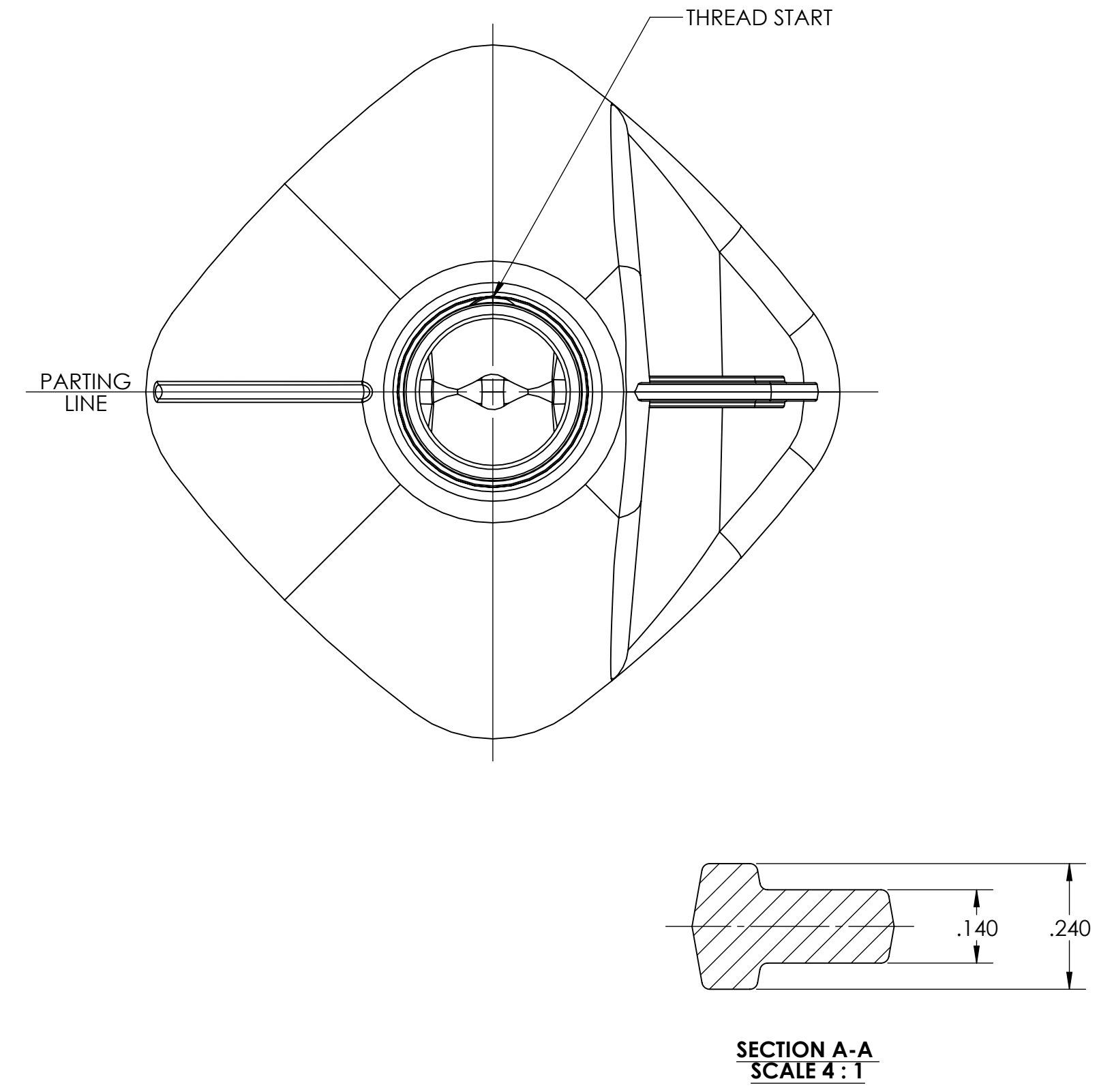
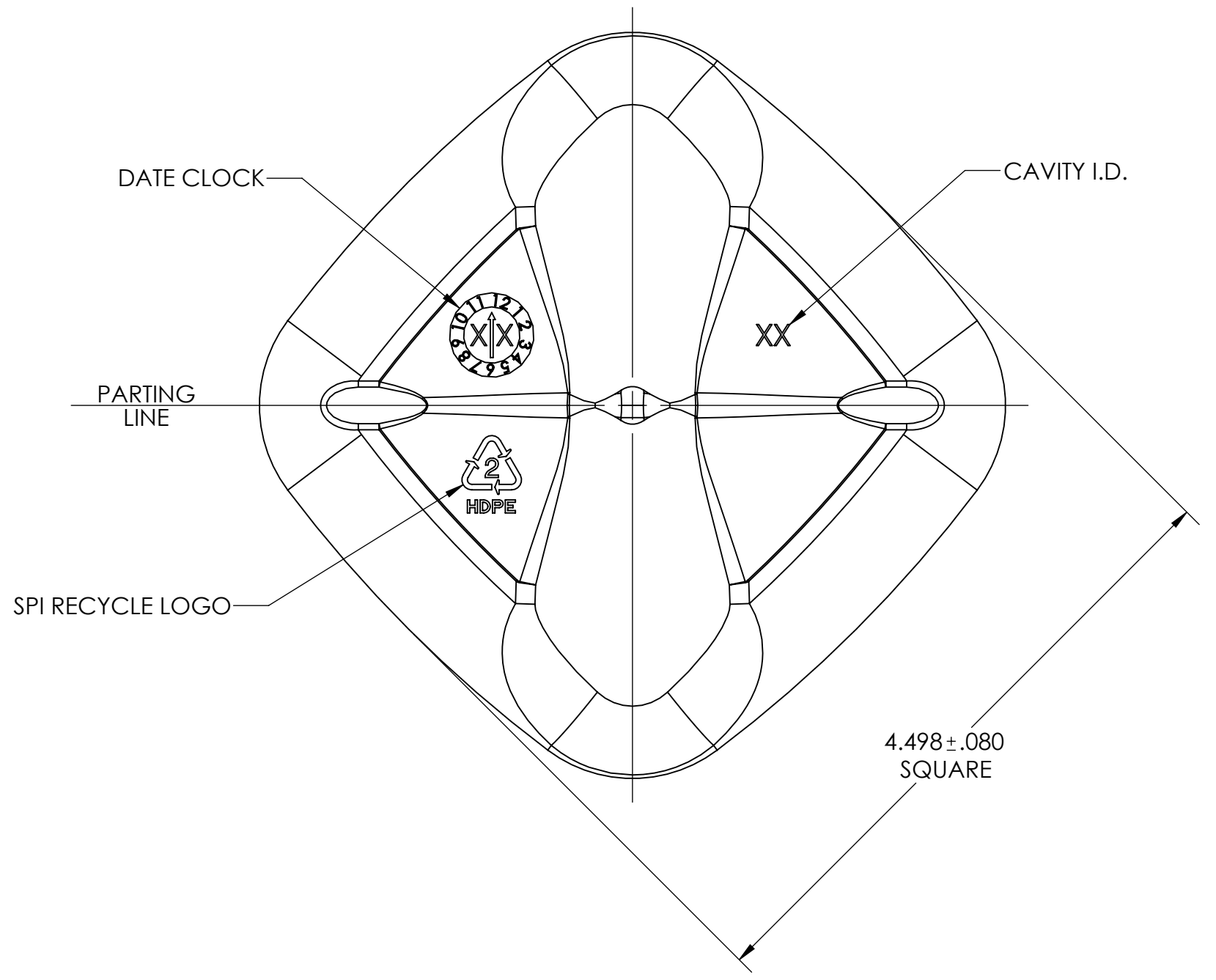
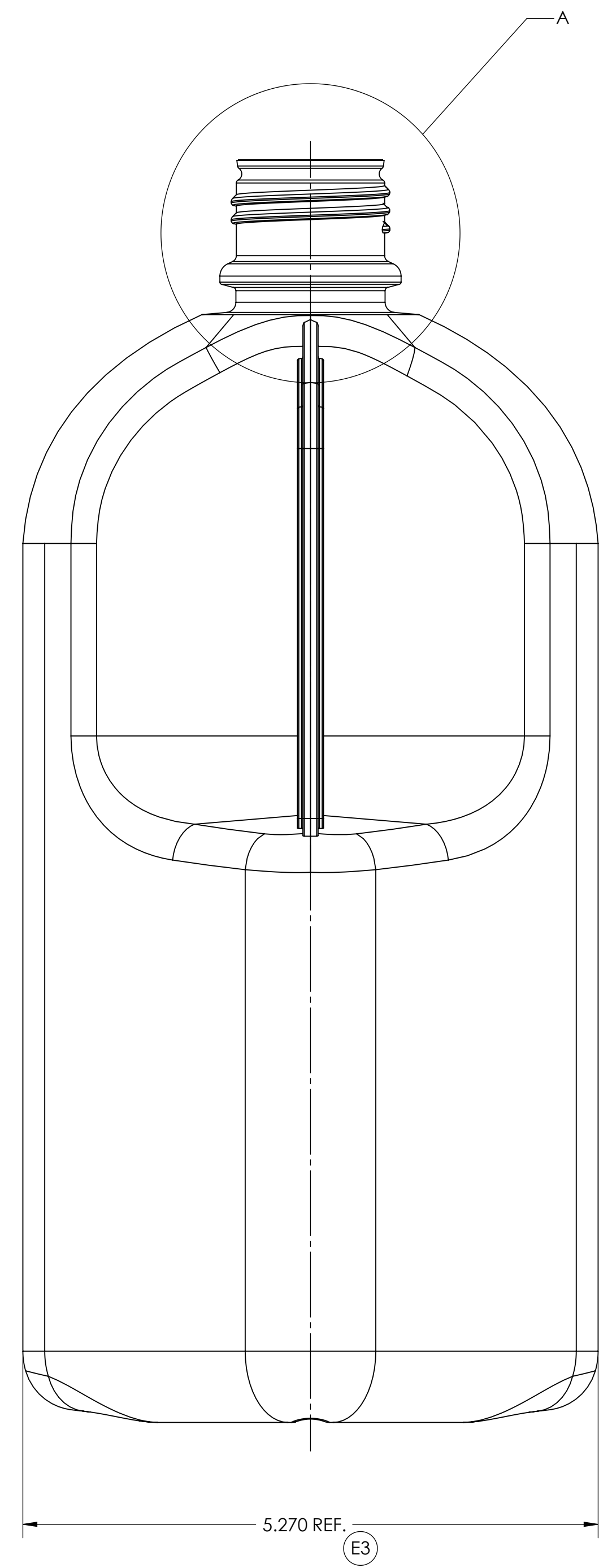
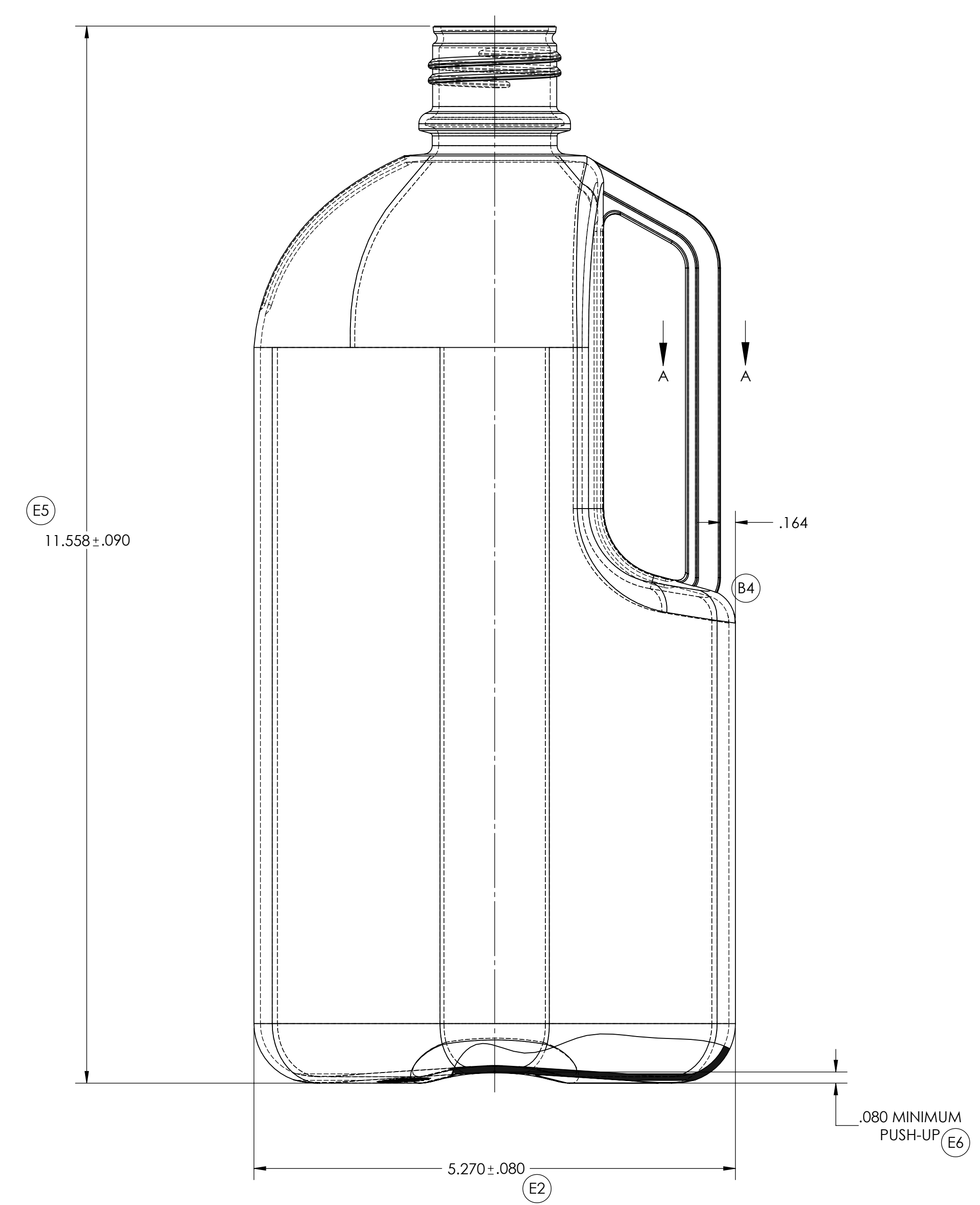
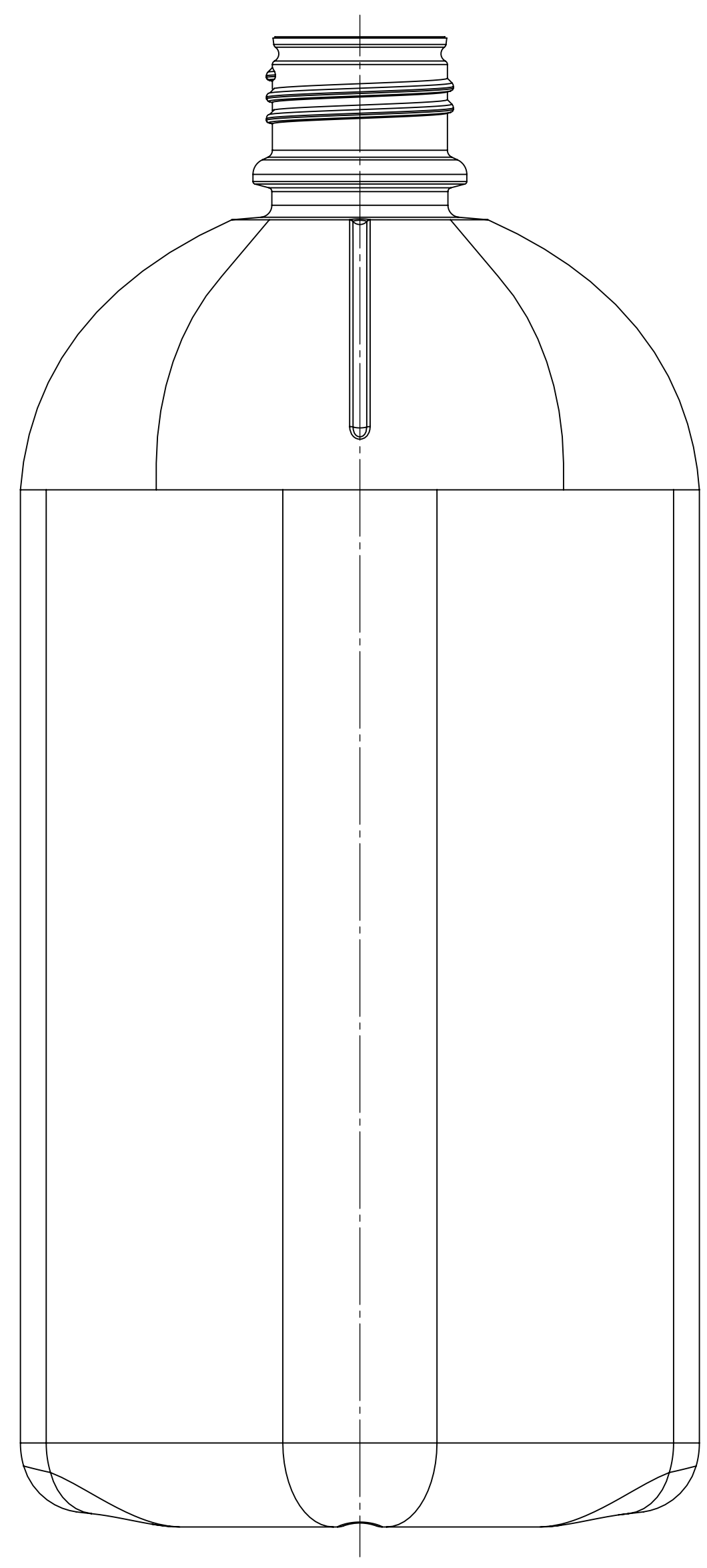

**NOTE:**  
 THE 2D & 3D GEOMETRY ASSOCIATED WITH THIS DRAWING ARE ONLY A REPRESENTATION OF THE CUSTOMER'S DRAWING AND MOLDS - WHICH HAVE BEEN DIGITIZED TO MAKE NEW MOLDS.  
 IN NO WAY SHOULD THE 3D FILE ASSOCIATED WITH THIS DRAWING EVER BE SENT TO A MOLD VENDOR TO CUT STEEL, AS IT MAY DIFFER FROM THE ACTUAL EXISTING MOLD GEOMETRY.

**MOLD #8930**

REFERENCE:  
#D08-045-RevC

PART DATA	
MATERIAL	PPQ Resin - Natural
ESTIMATED WEIGHT	208.0gr ± 8.0gr
OVERFLOW CAPACITY	2390.0ml ± 30.0ml
NECK FINISH	38-439 Special Neck
MAXIMUM SLANT (W 0°, 90°, 180°, 270°)	.030°

TOLERANCE UNLESS SPECIFIED		DATE	
xxx ±.031	DATE	11/12/2004	11/12/2004
xx ±.063	DATE	11/12/2004	11/12/2004
x ±.094	DATE	11/12/2004	11/12/2004
Fractional ±.188	DATE	11/12/2004	11/12/2004
Angles ±.12°	DATE	11/12/2004	11/12/2004

THIS DRAWING IS NOT A CONTROLLED DOCUMENT IF PRINTED OR COPIED FROM THE APPROVED LOCATION		CONFIDENTIAL	
DATE	11/12/2004	DATE	11/12/2004
TIME	4:26:38 PM	TIME	4:26:38 PM
DATE	11/12/2004	DATE	11/12/2004
TIME	4:26:38 PM	TIME	4:26:38 PM

PART DATA	
MATERIAL	PPQ Resin - Natural
ESTIMATED WEIGHT	208.0gr ± 8.0gr
OVERFLOW CAPACITY	2390.0ml ± 30.0ml
NECK FINISH	38-439 Special Neck
MAXIMUM SLANT (W 0°, 90°, 180°, 270°)	.030°

MOLD #8930	
DATE	11/12/2004
TIME	4:26:38 PM
DATE	11/12/2004
TIME	4:26:38 PM