

PRODUCTION RELEASE

NOTES: ©

- DO NOT SCALE DRAWING
- ALL NECK FINISH DIAMETER DIMENSIONS ARE THE AVERAGE OF TWO MEASUREMENTS TAKEN ACROSS THE MAJOR AND MINOR AXES. THE LIMITS OF OF OVALITY ARE (.024)
- THREAD SPECS = SINGLE LEAD, 6T.P.I. (.1667) PITCH, 2 REVOLUTIONS OF FULL THREAD DEPTH
- MIN WALL THICKNESS THRU BODY = .032
- MAX WALL VARIATION THRU PANEL = .030
- MIN WALL THICKNESS AT HEEL = .025

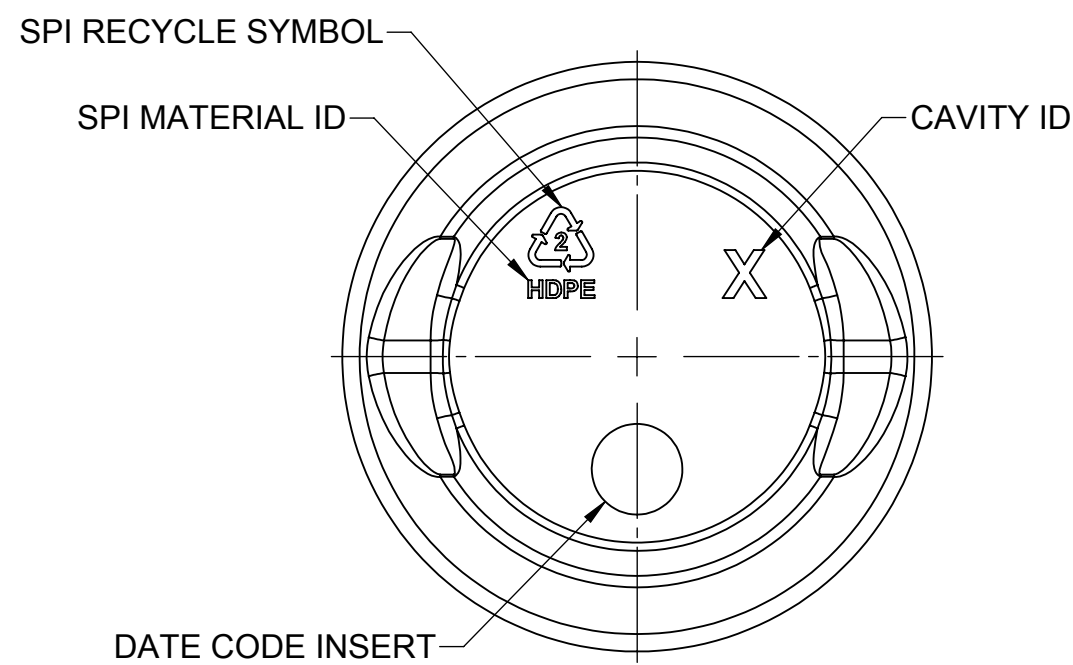
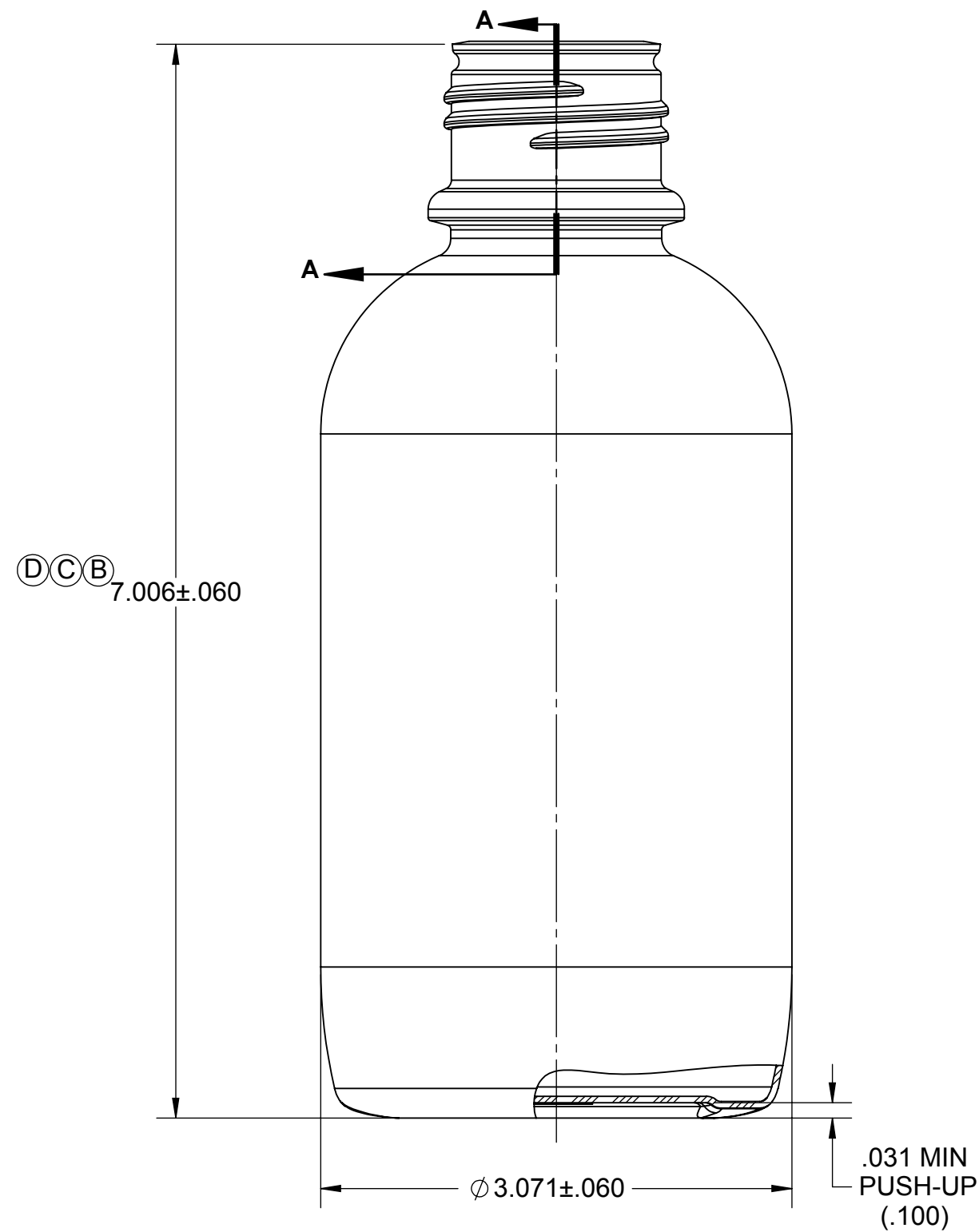

LET	REVISION DESCRIPTION	BY	ECN #	DATE
A	ORIGINAL RELEASE	KRM	81129944	4/19/2012
B	6.906 ± .060 WAS 6.985 ± .060, "I" Ø 1.137 ± .015 WAS "I" Ø 1.110 MIN (Ø 1.137), ADDED ± .015 TO Ø 1.357, 607.3cc WAS 614.5cc, REMOVED .020 STEP, R.020 & Ø 1.337	KRM	81129944-1	5/10/2012
C	7.000 ± .060 WAS 6.906 ± .060, 626.0cc ± 13.0cc WAS 607.3cc ± 13.0cc, REVISED DIMS TO REFLECT MOLDED RESULTS: "S".247 ± .015 WAS "S".241 ± .015, "E" Ø 1.374 ± .010 WAS "E" Ø 1.367 ± .010, "K" Ø 1.365 ± .015 WAS Ø 1.357 ± .015, ADDED MIN/MAX WALL SPECS (NOTES 4, 5, & 6), 50.0g ± 2.5g WAS 50.0g ± 2.0g RELEASED FOR PRODUCTION	KRM	81345898	11/27/2012
D	UPDATED DRAWING TEMPLATE, ADDED 10° BEVEL TO TOP LAND, 7.006 ± .060 WAS 7.000 ± .060, "K" Ø 1.366 ± .015 WAS "K" Ø 1.365 ± .015,	KRM	RCT130374	12/20/2013

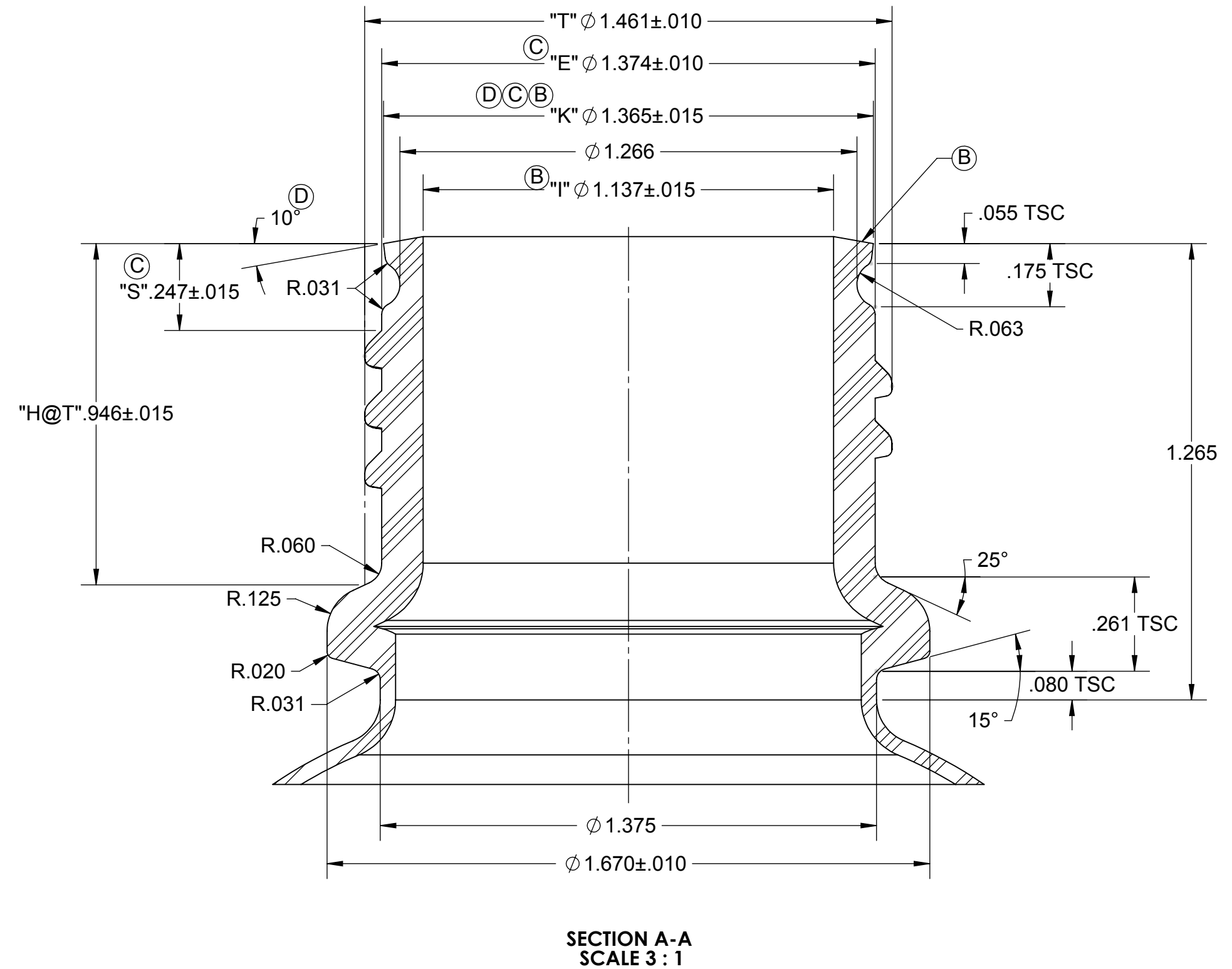

NOTE:
 THE 2D & 3D GEOMETRY ASSOCIATED WITH THIS DRAWING ARE ONLY A REPRESENTATION OF THE CUSTOMER'S DRAWINGS AND MOLDS - WHICH HAVE BEEN DIGITIZED TO MAKE NEW MOLDS.
 IN NO WAY SHOULD THE 3D FILE ASSOCIATED WITH THIS DRAWING EVER BE SENT TO A MOLD VENDOR TO CUT STEEL, AS IT MAY DIFFER FROM THE ACTUAL EXISTING MOLD GEOMETRY.

MOLD #8934

PART DATA	
MATERIAL	HDPE
ESTIMATED WEIGHT	50.0g ± 2.5g
OVERFLOW CAPACITY	626.0cc ± 13.0cc
NECK FINISH	38mm SPECIAL

(.XXX) ARE REFERENCE DIMENSIONS (.XXX) ARE INSPECTION DIMENSIONS	
THIS DRAWING IS NOT A CONTROLLED DOCUMENT IF PRINTED OR COPIED FROM THE APPROVED LOCATION	
CONFIDENTIAL	
TOLERANCE UNLESS SPECIFIED xxx +/- .031 xx +/- .063 x +/- .094 Fractional +/- 1/8" Angles +/- 1/2°	BERRY PLASTICS CORPORATION AND SUBSIDIARIES LEADERSHIP BY DESIGN 101 OAKLEY STREET EVANSVILLE, INDIANA 47706 TEL. (812) 424-2904 LAST MODIFIED BY AND DATE: bsharp - 9/11/2014 11:15:31 AM
JDE TOOL NUMBER: ZB38RD500H	DRAWING TYPE: CUSTOMER
DESCRIPTION: 500mL (38mm NECK) PUREPAK	
DRAWING NO: CP-120366-PRT01	PROJECT NUMBER: 120366
CREATED BY: K. MCWILLIAMS	CREATION DATE: 04/18/12
DRAWING REVISION: D	SHEET: 1 of 1
SCALE: 1:1	SHEET SIZE: C