

NOTES: ^(C)

1. DO NOT SCALE DRAWING
2. ALL NECK FINISH DIAMETER DIMENSIONS ARE THE AVERAGE OF TWO MEASUREMENTS TAKEN ACROSS THE MAJOR AND MINOR AXES. THE LIMITS OF OVALITY ARE (.024)
3. THREAD SPECS = SINGLE LEAD, 4mm (.1575) PITCH, 3 REVOLUTIONS OF FULL THREAD DEPTH
- ^(D) 4. MIN WALL THROUGH PANEL TO BE .032
5. MIN WALL AT HEEL TO BE .023

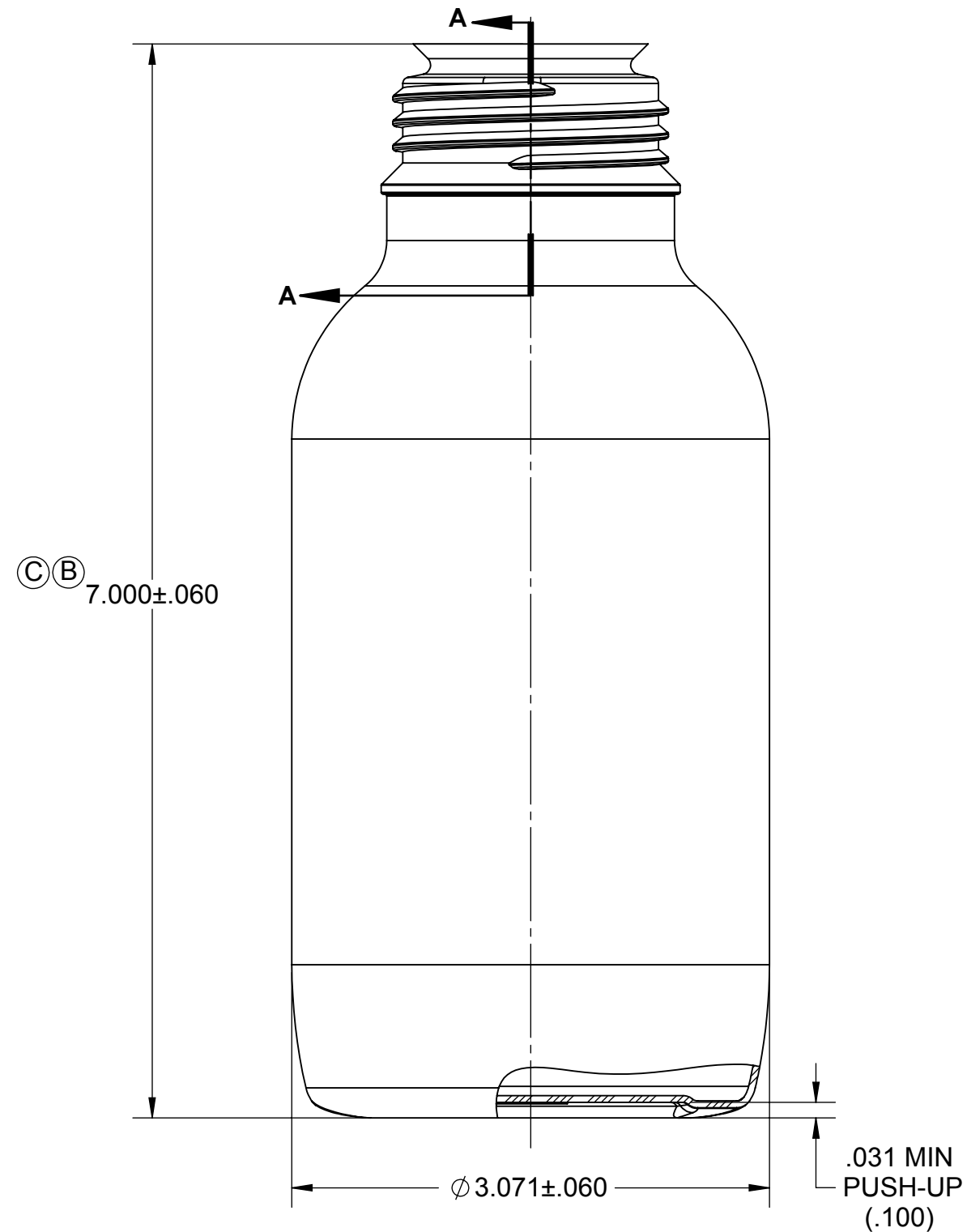

LET	REVISION DESCRIPTION	BY	ECN #	DATE
A	ORIGINAL RELEASE	KRM	81129944	4/18/2012
B	6.906 WAS 7.007, 624.9cc WAS 637.3cc, "I" ϕ 1.137 ± .015 WAS "I" ϕ 1.110 MIN (ϕ 1.137), ADDED DIMS R.039, R.010	KRM	81129944-1	5/11/2012
C	ADDED NOTES 4 & 5, UPDATED DIMS PER MOLDED RESULTS: 7.000 ± .060 WAS 6.906 ± .060, ϕ 1.490 ± .020 WAS ϕ 1.512 ± .010, 50.0 g ± 2.5 g was 50.0 g ± 2.0 g, 640.3cc ± 13.0cc WAS 624.9cc ± 13.0cc	KRM	30886462	3/6/2013
D	.032 WAS .035, RELEASED FOR PRODUCTION	KRM	30886462-1	4/30/2013

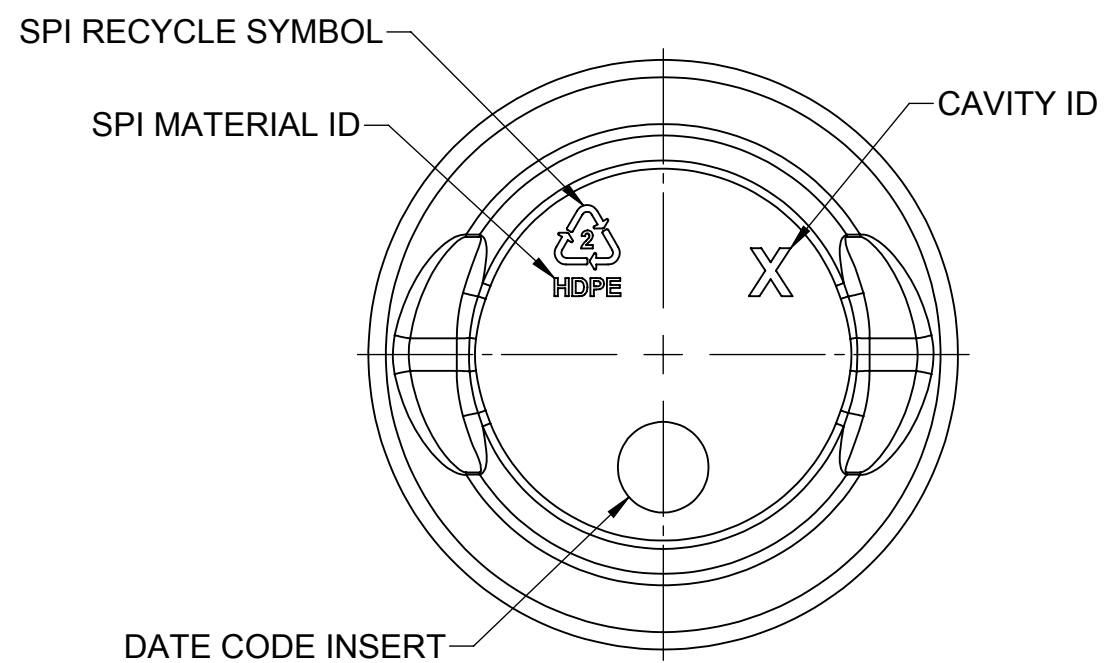
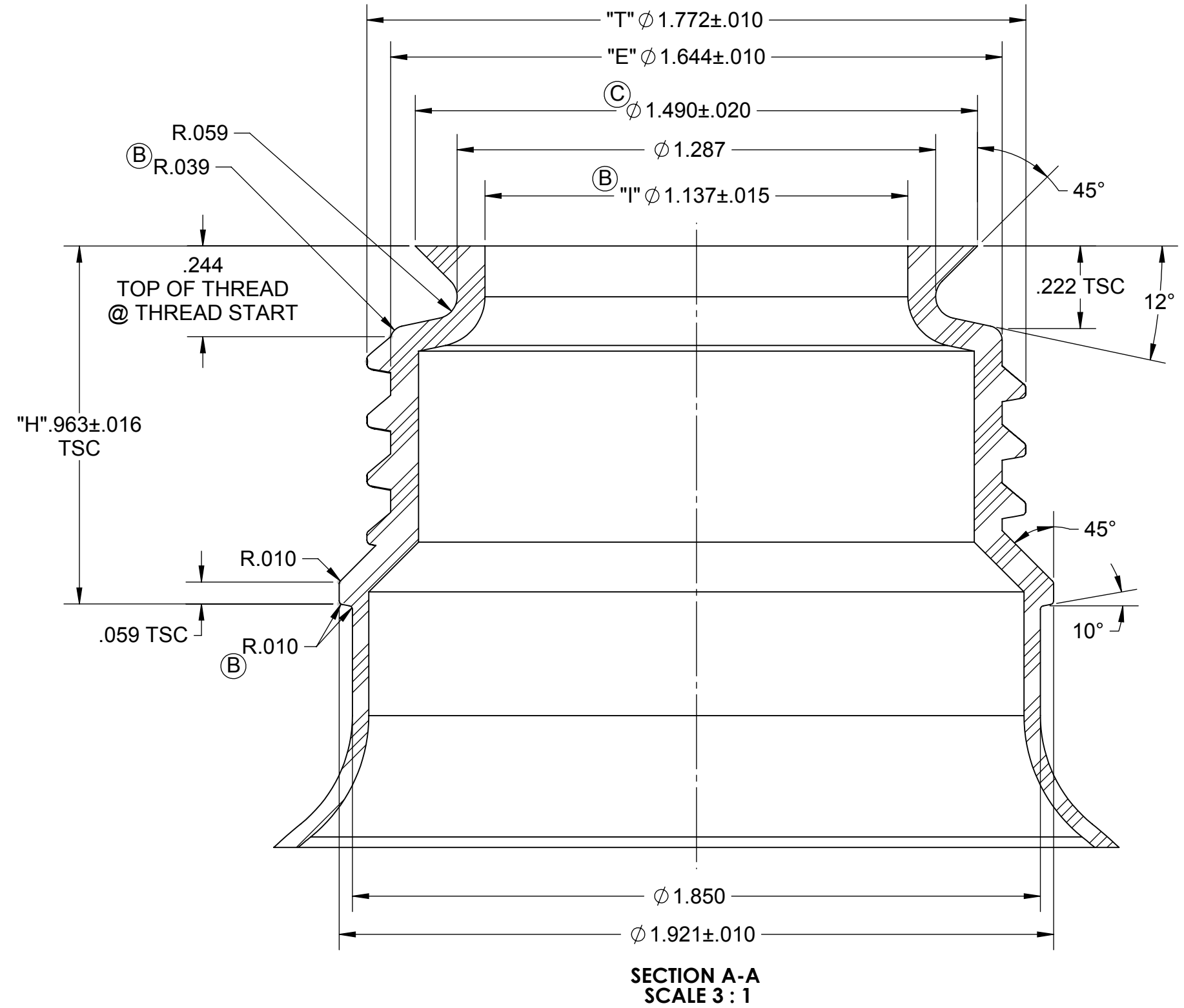

NOTE:
THE 2D & 3D GEOMETRY ASSOCIATED WITH THIS DRAWING ARE ONLY A REPRESENTATION OF THE CUSTOMER'S DRAWING AND MOLDS - WHICH HAVE BEEN DIGITIZED TO MAKE NEW MOLDS.

IN NO WAY SHOULD THE 3D FILE ASSOCIATED WITH THIS DRAWING EVER BE SENT TO A MOLD VENDOR TO CUT STEEL, AS IT MAY DIFFER FROM THE ACTUAL EXISTING MOLD GEOMETRY.

MOLD #8935

PART DATA	
MATERIAL	HDPE
ESTIMATED WEIGHT	50.0g ± 2.5g
OVERFLOW CAPACITY	640.3cc ± 13.0cc
NECK FINISH	45mm SPECIAL

$\overline{\text{XXX}}$	$\overline{(.XXX)}$	$\overline{.XXX}$
BASIC DIMENSIONS	REFERENCE DIMENSIONS	INSPECTION DIMENSIONS

THIS DRAWING IS NOT A CONTROLLED DOCUMENT IF PRINTED OR COPIED FROM THE APPROVED VAULTING LOCATION

THIS DRAWING HAS BEEN RELEASED FOR PRODUCTION.

TOLERANCE UNLESS SPECIFIED	<p>BERRY PLASTICS CORPORATION AND SUBSIDIARIES LEADERSHIP BY DESIGN 101 OAKLEY STREET EVANSVILLE, INDIANA 47706 TEL. (812) 424-2904</p>	CONFIDENTIAL		THIS UNPUBLISHED WORK IS THE PROPERTY OF BERRY PLASTICS CORPORATION AND IS PROTECTED BY TRADE SECRET, COPYRIGHT AND OTHER INTELLECTUAL PROPERTY LAWS AND MAY ALSO BE SUBJECT TO A SPECIFIC OR GENERAL CONFIDENTIALITY AGREEMENT. IT IS NOT TO BE VIEWED BY UNAUTHORIZED PERSONS OR DUPLICATED IN ANY MEDIUM FOR PURPOSES OTHER THAN THOSE FOR WHICH IT IS SPECIFICALLY FURNISHED. IN THE EVENT OF PUBLICATION, THE FOLLOWING NOTICE SHALL APPLY			
xxx +/- .031		PRODUCT NAME: ZB45RD500H	DRAWING TYPE: CUSTOMER				
xx +/- .063		DESCRIPTION: 500mL (45mm NECK) PUREPAK					
x +/- .094		DRAWING NO.: CP-120367-PRT01	PROJECT #: 120367				
Fractional +/- 1/8"		CREATED BY: K. MCWILLIAMS	CREATION DATE: 04/17/12	SHEET 1 of 1	DRAWING VERSION D.2	SCALE: 1:1	SHEET SIZE C
Angles +/- 1/2°							